

# LOOP PLACEMENT GUIDE

## FAST HIGH CUT



## FAST SUPER HIGH CUT



## SENTRY



## ACH / TBH



[www.ops-core.com](http://www.ops-core.com)



# UNIVERSAL EXTERIOR LOOP KIT

OPERATOR'S MANUAL



## COLOR



TAN



FOLIAGE GREEN



BLACK



URBAN GRAY

For FAST®, Sentry, ACH and TBH Helmet Systems

This product is covered by one or more patents.  
For more information visit [www.gentexcorp.com/patents](http://www.gentexcorp.com/patents)

© OPS-CORE 2017 UM-1039 REV. A

# HELMET SHELL PREPARATION

## 1 CAREFULLY REMOVE OLD LOOP

**WARNING: DO NOT FORCEFULLY RIP THE LOOP OFF. THIS WILL CAUSE SEVERE DAMAGE TO THE PAINT ON THE HELMET SHELL.**

Using your fingers, carefully peel the Loop away from the helmet shell. **DO NOT FORCEFULLY RIP THE LOOP OFF!** Continue this process by slowly pulling it back until all Loop is removed.

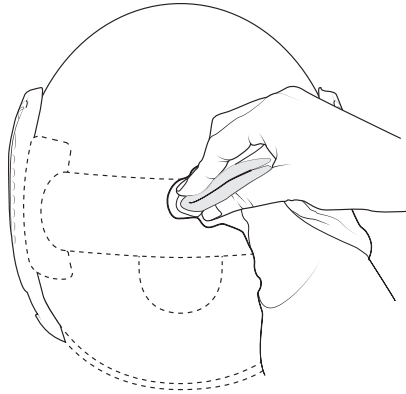
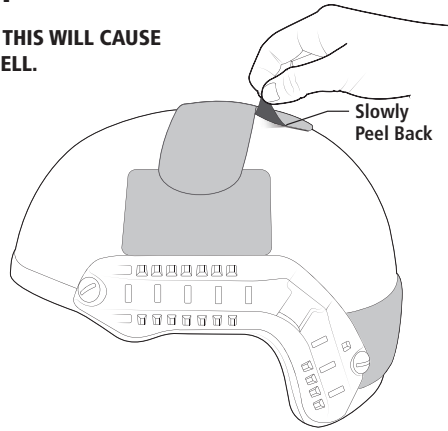

## 2 CLEAN THE HELMET SHELL

To remove excess adhesive from old Loop and to ensure optimal adhesion of new Loop, gently rub affected areas with a clean towel and Isopropyl Rubbing Alcohol. Do not use harsh chemicals. If traces of adhesive remain, you can use Goo Gone® to remove stubborn residue. Wipe the area with alcohol again after use. Allow the helmet to dry before attempting to place new Loop onto the shell's surface.

## 3 PLACEMENT PREPARATION

Using the "Loop Placement Guide" on the back page and the "New Loop Installation" steps to the right, carefully align all Universal Exterior Loop pieces to their proper positions. Test fit all pieces before removing the backing. The adhesive on the Loop is pressure sensitive. Once in place it needs to be pressed down firmly. Allow up to 24 hours for adhesive to reach maximum bonding strength.

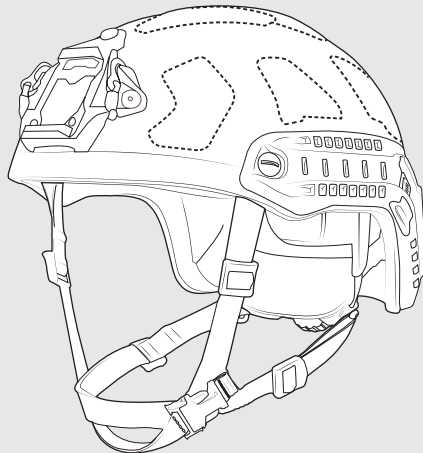

**\*ALL DIAGRAMS AND INSTALLATION PHOTOS ARE SHOWING THE FAST BALLISTIC HIGH CUT HELMET. YOUR HELMET SHELL AND LOOP PLACEMENT MAY VARY.**

# NEW LOOP INSTALLATION

## 4 INSTALL REAR LOOP

Using the rear section of the ARCs as a reference, center and apply the rear loop patch on the back of the helmet. The lower edge of the rear loop patch should be level.

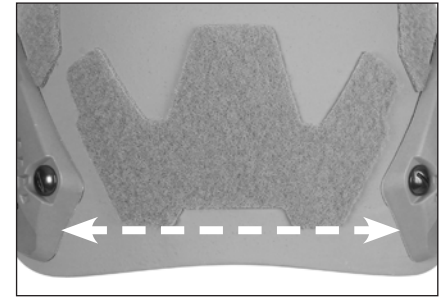

## 5 INSTALL SIDE RAIL LOOP

Using the first notch on the front of the ARCs as a reference, align and apply the front rail loop patch. Using the corner section of the rail as a reference, align and apply the rear rail loop patch. Mirror this process on the other side of the helmet.

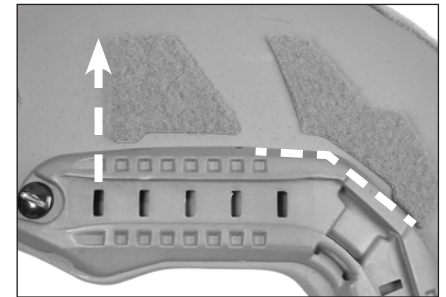

## 6 INSTALL FRONT LOOP

Using the shroud and the ARCs as a reference, center and apply the front loop patches. The notched section of the front loop patch should be evenly offset from the rounded corner of the shroud.

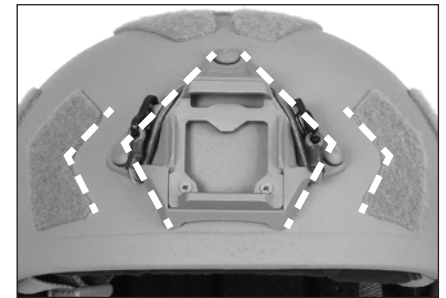

## 7 INSTALL TOP LOOP

Using the top corner and rear loop patch as reference, find the center of the helmet. Align and apply the top loop patches as shown on the loop placement guide. The gaps between these loop patches may vary depending on the size and type of the helmet.

