



H-NAPE

HEAD-LOC® 4-POINT CHINSTRAP



MADE IN USA

FEATURES

- Makes helmet 3X more stable under rotational forces
- Sliders allow one-handed on-the-fly strap adjustment
- Unique strap geometry and design eliminate loose ends
- Padded leather chin cup and nape pad for extra comfort
- Available in LED (left-eye dominant, buckle on right side)
- Available in Tan, Green and Black

SIZE

- ONE SIZE
- S/M
- L/XL
- LED

COLOR

- TAN
- GREEN
- BLACK

INSTALLATION INSTRUCTIONS

PACKAGE CONTENTS = (1) Head-Loc® H-Nape Chinstrap, and the following ballistic installation hardware:

x4 Ballistic Screws* **x4 T-Nuts**

*Longer screws are available for special applications.

1 REMOVE OLD CHINSTRAP

Use a screwdriver or large coin to loosen the screws and remove your old chinstrap.

2 INSTALL HEAD-LOC CHINSTRAP

Using a screwdriver or large coin, follow the diagram on the right to properly install all four Strap Anchors as shown.

NOTE: BE SURE TO COVER THE ANCHOR HARDWARE WITH THE HELMET'S COMFORT / SUSPENSION PADS.

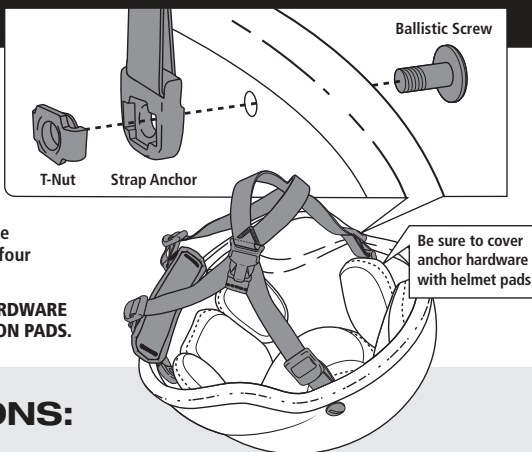

FITTING INSTRUCTIONS:

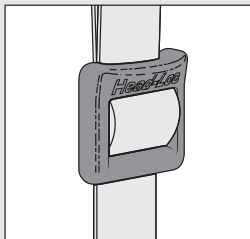

1 LOOSEN HEAD-LOC SLIDERS

Loosen all (4) Head-Loc Sliders by sliding them away from the chin cup.

2 CONNECT CHINSTRAP BUCKLE

Place the helmet on your head and connect the low profile chinstrap buckle. This is easiest when placing your index fingers behind each side of the buckle as shown.

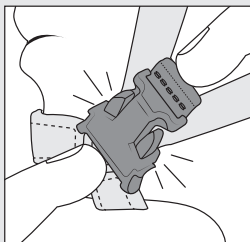

3 TIGHTEN FRONT HEAD-LOC SLIDERS

Tighten the front straps by pulling the Head-Loc Sliders toward your chin. This is easiest when holding either side of the slider with your thumb and middle finger while using your index finger in the top recess.

4 ADJUST NAPE PAD

Position comfortably (as low as possible) on the back of your head. Pull Head-Loc Slider with your right hand.

5 TIGHTEN SIDE STRAPS

Tighten the side straps by pulling the Head-Loc Sliders toward your chin. This is easiest when holding either side of the slider with your thumb and middle finger while using your index finger in the top recess.

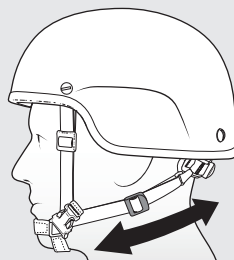
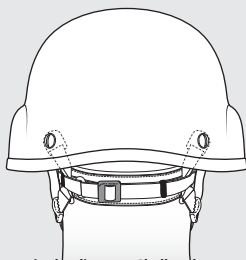

ACH helmet shown in the diagram. Shell and suspension may vary.



OPS-CORE, INC.
Marine Industrial Park
12 Channel Street
Boston, MA 02210

Tel: 617.670.3547
Fax: 617.670.3581

Or visit our website
at www.ops-core.com